

NCCC OFFICIAL FLYER



West Region



CORNHUSKER CORVETTE CLUB

PRESENTS

PEOPLE'S CHOICE CONCOURS

September 6th, 2008

LOCATION: Sid Dillon Chevrolet, 2500 E. 23rd Street, Fremont, NE 68025

SANCTION NUMBER: WR-095-912

SCHEDULE: Optional Caravan: Drivers Meeting: 9:00 AM – Departs Omaha 9:15 AM
(Central Time Zone) Registration: Opens 10:00 AM – Closes 10:45 AM
PC Concours Drivers Meeting: 11:00 AM
Show/Vote: 11:00 AM – 2:00 PM
Awards Presentation: 2:00 PM

COST: No Entry Fee

INFORMATION: Join the caravan from Omaha to Fremont or drive directly to Sid Dillon Chevrolet. (See caravan details on next page.)

Park in the assigned area near the showroom, sign the K&K waiver, register for the PC Concours, and check out all the new Chevrolet products on display. Lunch will be provided at no charge by Sid Dillon. Coffee, water, soft drinks, and restrooms will be available on site. *Participants are encouraged to bring chairs and protection from overexposure to sunlight.* **THIS IS A CORVETTES ONLY EVENT.**

CCC EVENT CHAIRPERSONS & EVENT COORDINATORS:

Ken & Pattie Bena, 13964 Frederick Circle, Omaha, NE. 68138-6222 Phone: 402.896.9370

CCC CARAVAN LEADER: Bob & Kris Speckmann Phone: 402.493.8776

CCC GOVERNOR:

Anita Poss, 12006 Washington Plaza, Omaha, NE. 68137 Phone: 402-895-2242
eaposs@aol.com.

PEOPLE'S CHOICE CONCOURS
September 6th, 2008

Optional Caravan

Participants coming from (or through) Omaha may wish to join the CCC caravan from Baker's Supermarket to Sid Dillon Chevrolet in Fremont.

Baker's is located at 13250 W. Maple Road. The caravan will meet in the parking lot at 9:00 AM and leave at 9:15 AM. The route will be announced at the drivers meeting.

NOTE: The caravan is not NCCC sanctioned.

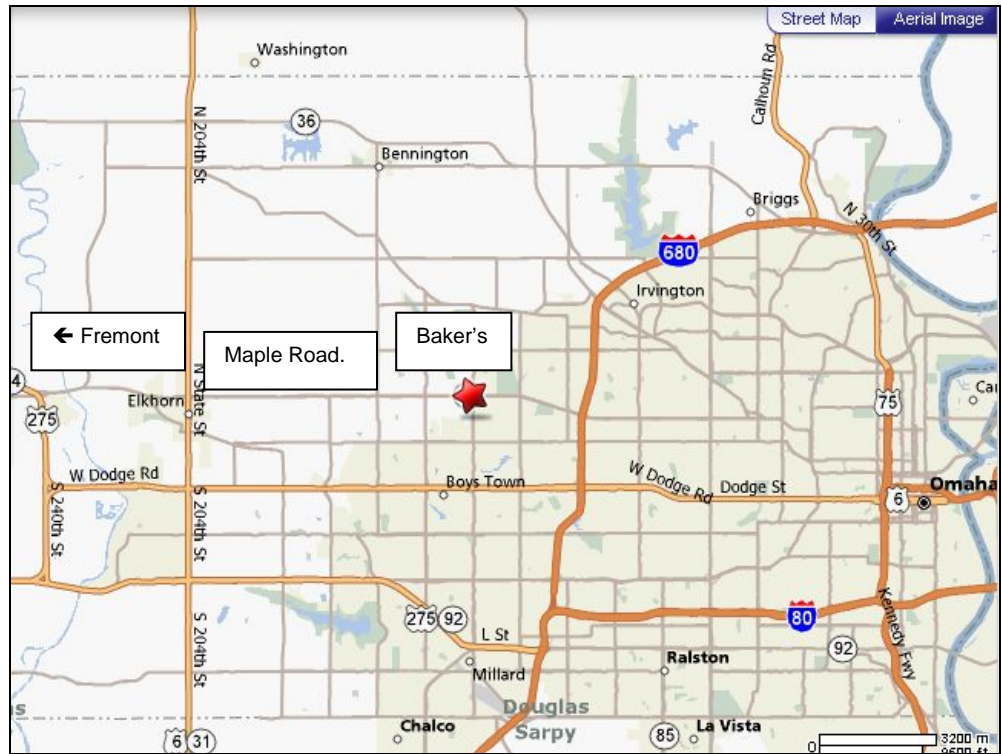

PC Concours

Sid Dillon Chevrolet is located near the northeast corner of Fremont on the north side of East US 30 (E. 23rd Street).

From Omaha:

- Go west on West Maple Road (NE 64) through Elkhorn to US 275, or go west on West Dodge Road to US 275.
- Go northwest on US 275 through Waterloo.
- Follow US 275 north to US 30.
- Go west on US 30 to Sid Dillon Chevrolet (on the right side).

